

eduard

LIMITED  
EDITION



# Eyes of the Fleet

INSTRUCTION SHEET

in cooperation with



1/72

2153-NAV 1

ATTENTION



UPOZORNĚNÍ



ACHTUNG



ATTENTION



注意



Carefully read instruction sheet before assembling. When you use glue or paint, do not use near open flame and use in well ventilated room. Keep out of reach of small children. Children must not be allowed to suck any part, or pull vinyl bag over the head.



Před započítím stavby si pečlivě prostudujte stavební návod. Při používání barev a lepidel pracujte v dobře větrané místnosti. Lepidla ani barvy nepoužívejte v blízkosti otevřeného ohně. Model není určen malým dětem, mohlo by dojít k požití drobných dílů.

INSTRUCTION SIGNS \* INSTR. SYMBOLS \* INSTRUKTION SINNBILDEN \* SYMBOLES \* 記号の説明

OPTIONAL  
VOLBABEND  
OHNOUTSAND  
BROUSITOPEN HOLE  
VYVRTAT OTVORSYMETRICAL ASSEMBLY  
SYMETRICKÁ MONTÁŽREMOVE  
ODRÍZNOUTREVERSE SIDE  
OTOČITAPPLY EDUARD MASK  
AND PAINT  
POUŽIT EDUARD MASK  
NABARVIT**PLEASE CHECK THE LATEST VERSION OF THE INSTRUCTIONS ON [www.eduard.com](http://www.eduard.com)**

PARTS



DÍLY



TEILE



PIÈCES



部品

A&gt;

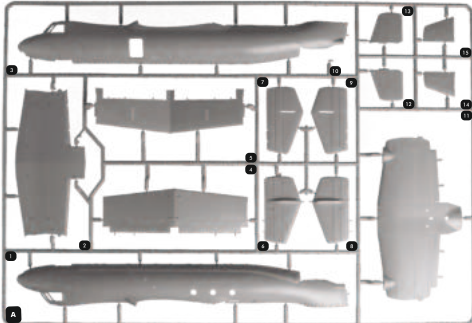

B&gt;

PLASTIC PARTS

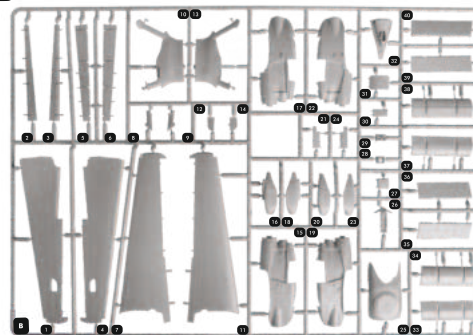

E&gt;

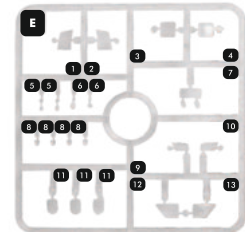

C&gt;

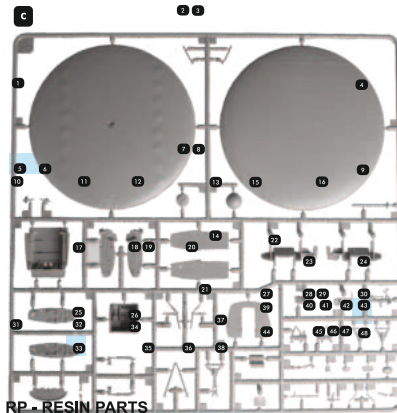

D&gt; 2 pcs.

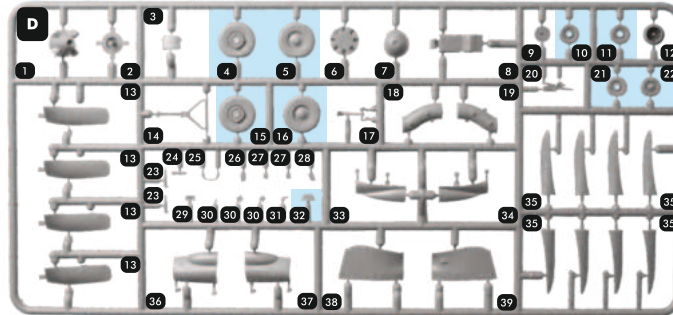
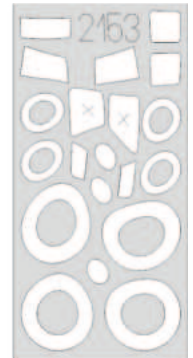
eduard  
MASK

RP - RESIN PARTS

eduard  
BRASSINR1  
2 pcs.R2  
2 pcs.

PE - PHOTO ETCHED DETAIL PARTS

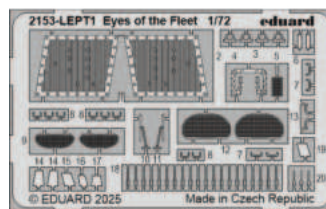

-Parts not for use. -Teile werden nicht verwendet. -Pièces à ne pas utiliser. -Tyto díly nepoužívejte při stavbě. - 使用しない部品

COLOURS



BARVY



FARBEN



PEINTURE



色

GSI Creos (GUNZE)		
AQUEOUS	Mr.COLOR	
H1	C1	WHITE
H2	C2	BLACK
H3	C3	RED
H5	C5	BLUE
H11	C62	FLAT WHITE
H12	C33	FLAT BLACK
H15	C65	BRIGHT BLUE
H33	C81	RUSSET
H47	C41	RED BROWN
H65	C18	RLM70 BLACK GREEN
H68	C36	RLM74 DARK GRAY
H69	C37	RLM75 GRAY
H70	C60	RLM02 GRAY
H77	C137	TIRE BLACK
H90	C47	CLEAR RED

GSI Creos (GUNZE)		
AQUEOUS	Mr.COLOR	
H94	C138	CLEAR GREEN
H315	C315	GRAY
H317	C317	GRAY
H326	C326	BLUE
H327	C327	RED
H329	C329	YELLOW
H413	C113	RLM04 YELLOW
H414	C114	RLM23 RED
H416	C116	RLM66 BLACK GRAY
H417	C117	RLM76 LIGHT BLUE
Mr.COLOR SUPER METALLIC		
SM201		SUPER FINE SILVER
SM203		SUPER IRON
SM204		SUPER STAINLESS
SM206		SUPER CHROME SILVER

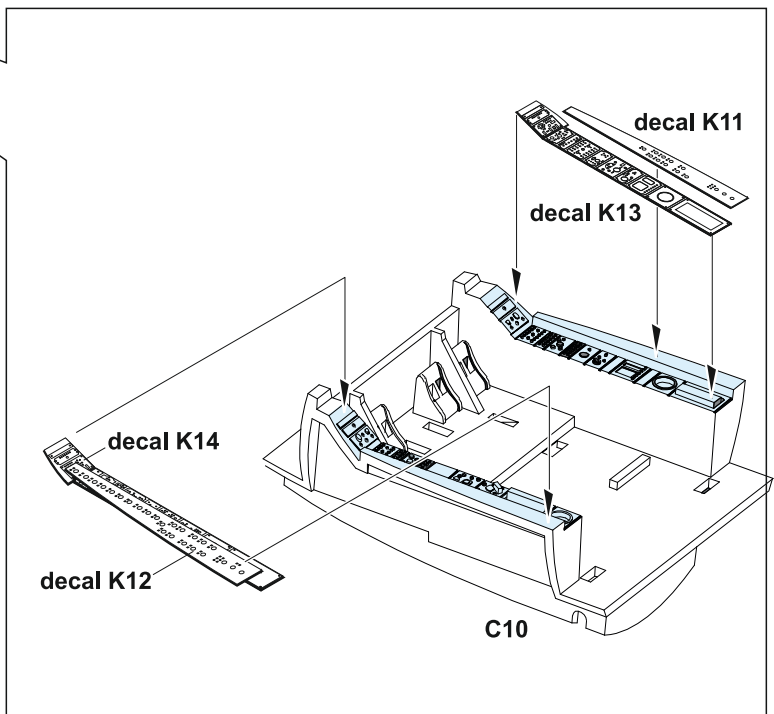
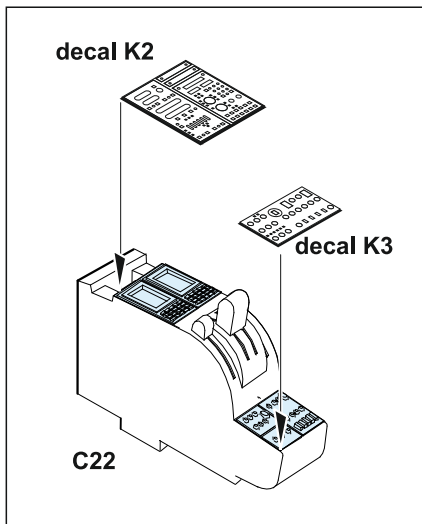
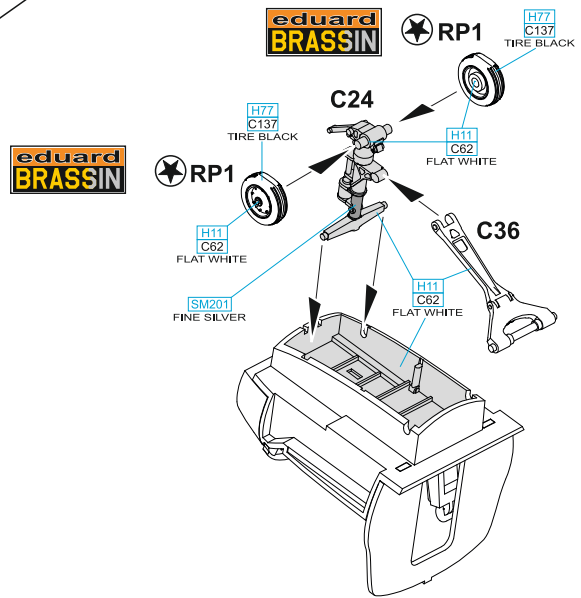
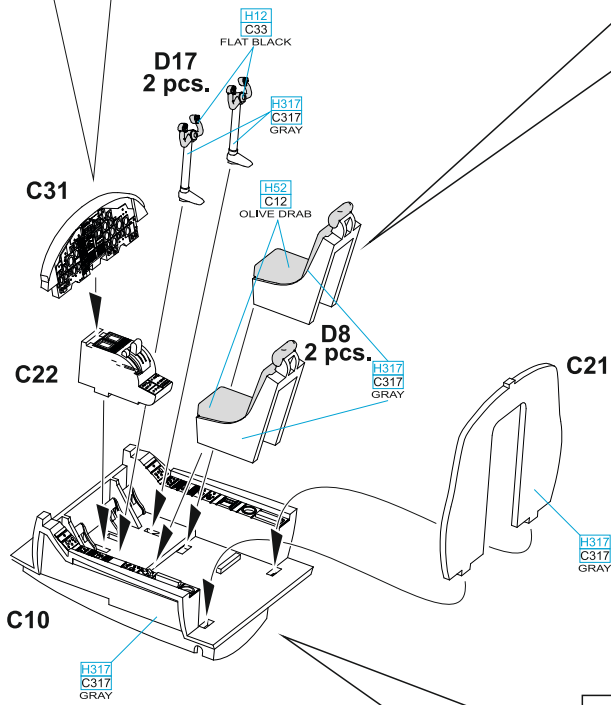
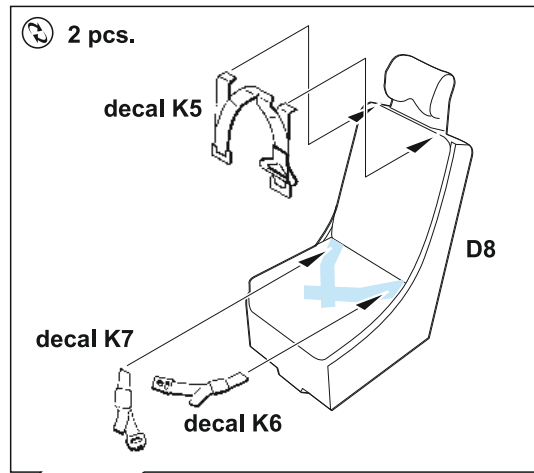
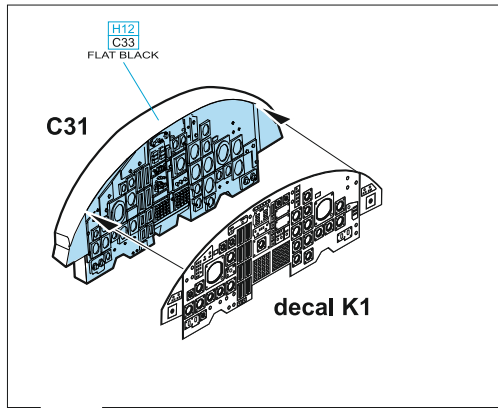

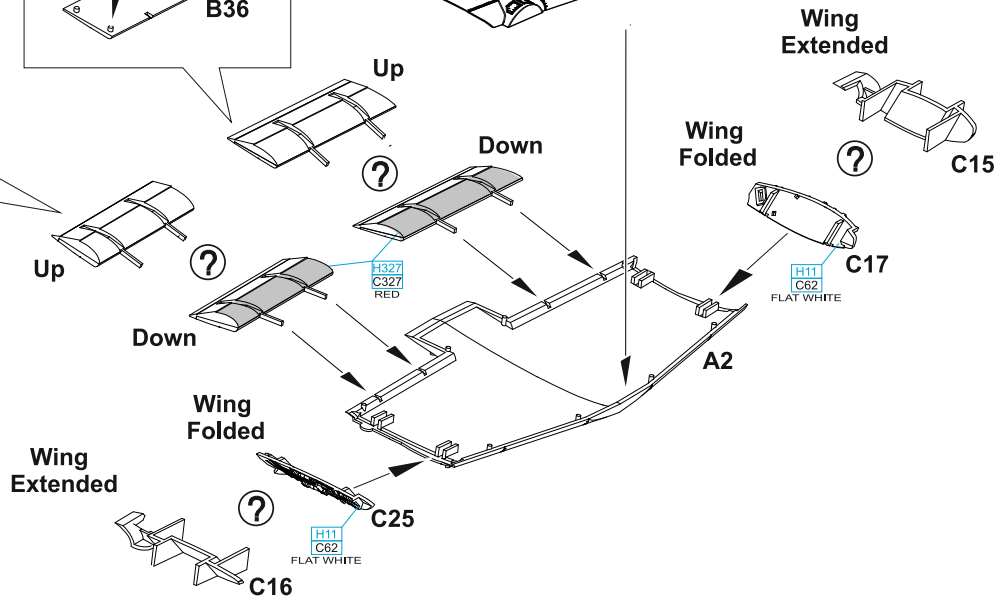
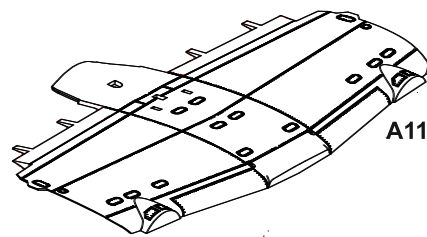
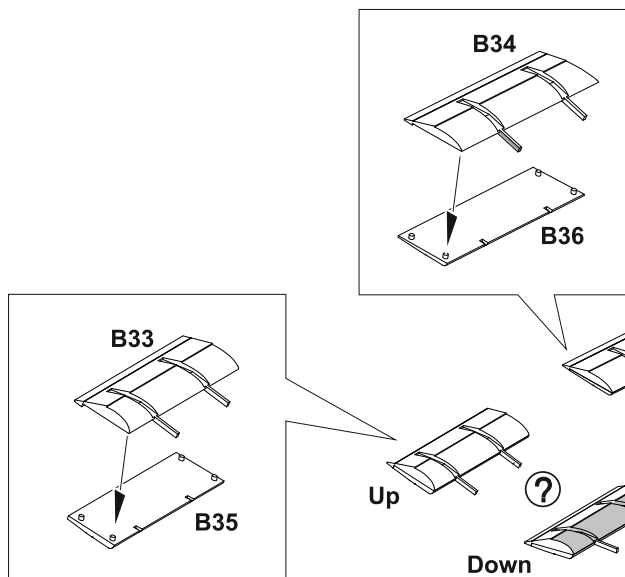
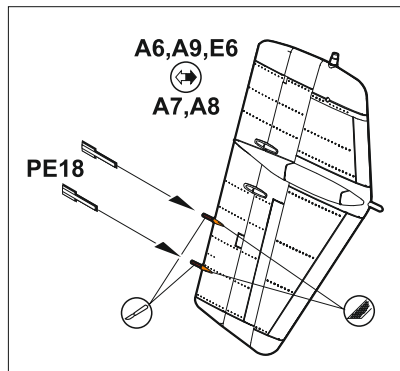
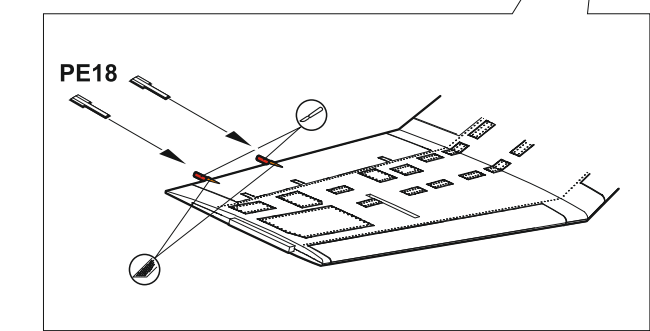
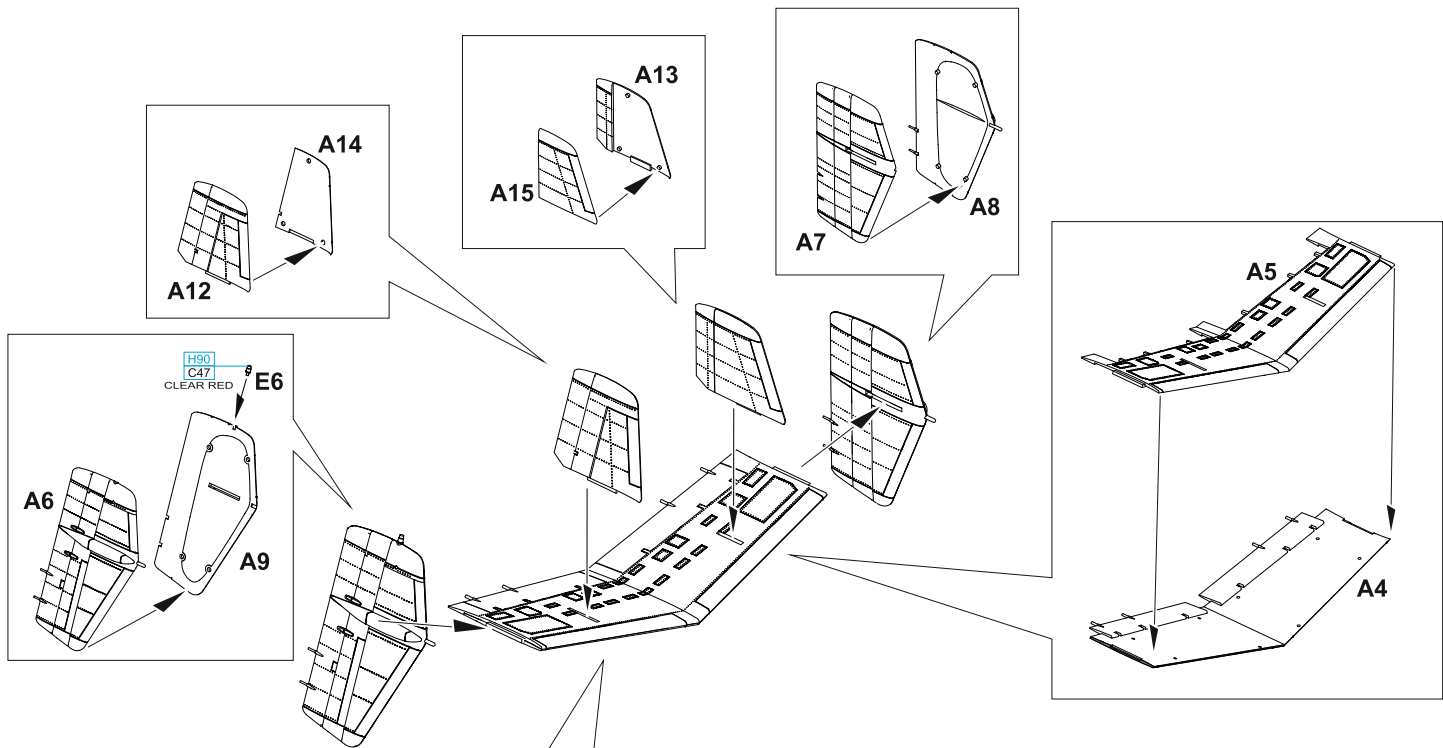

∅ - 0,2 mm  
 MARKINGS A, B, D ONLY

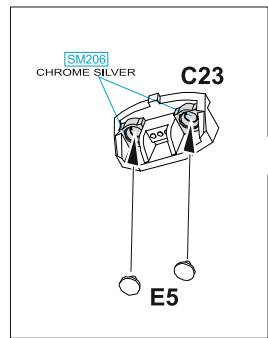
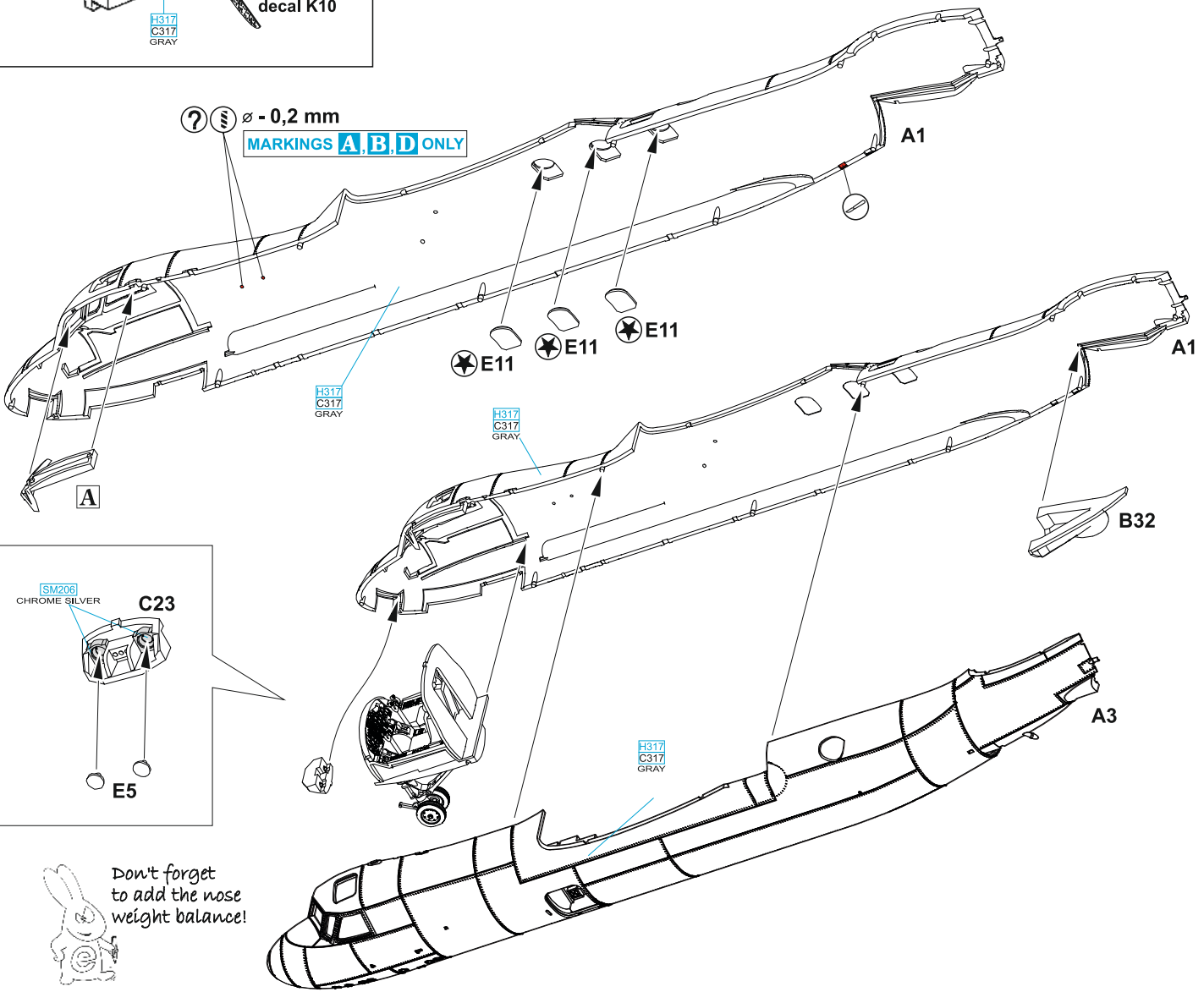
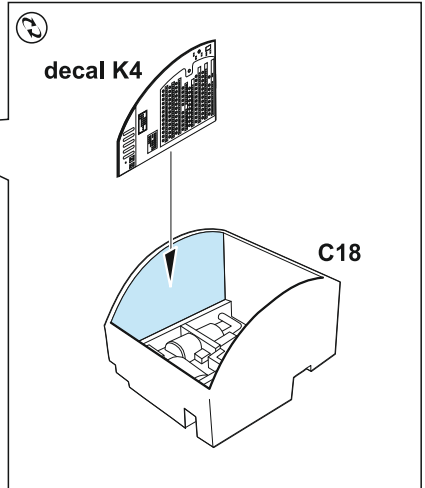
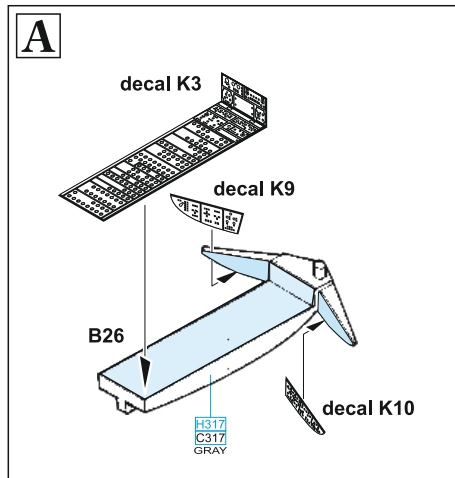
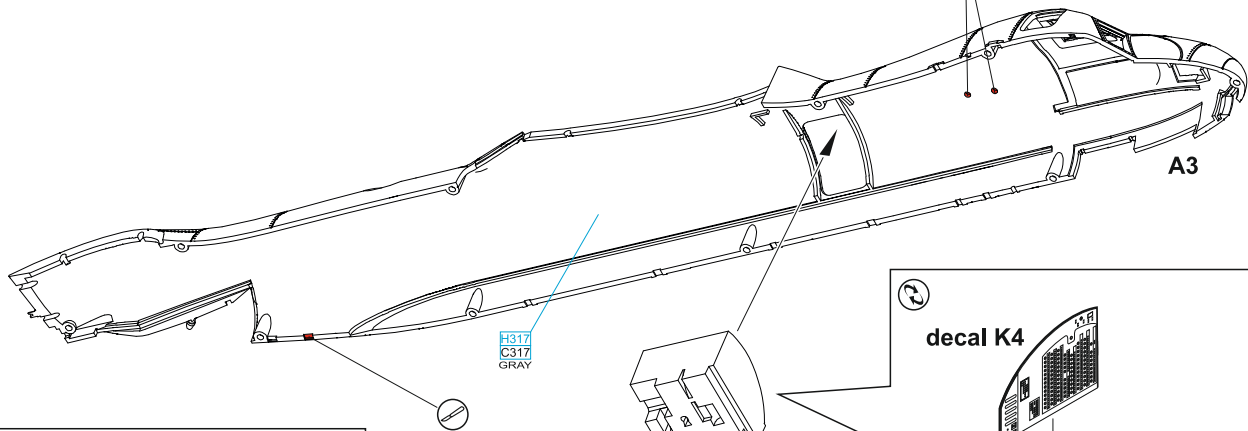

Don't forget to add the nose weight balance!

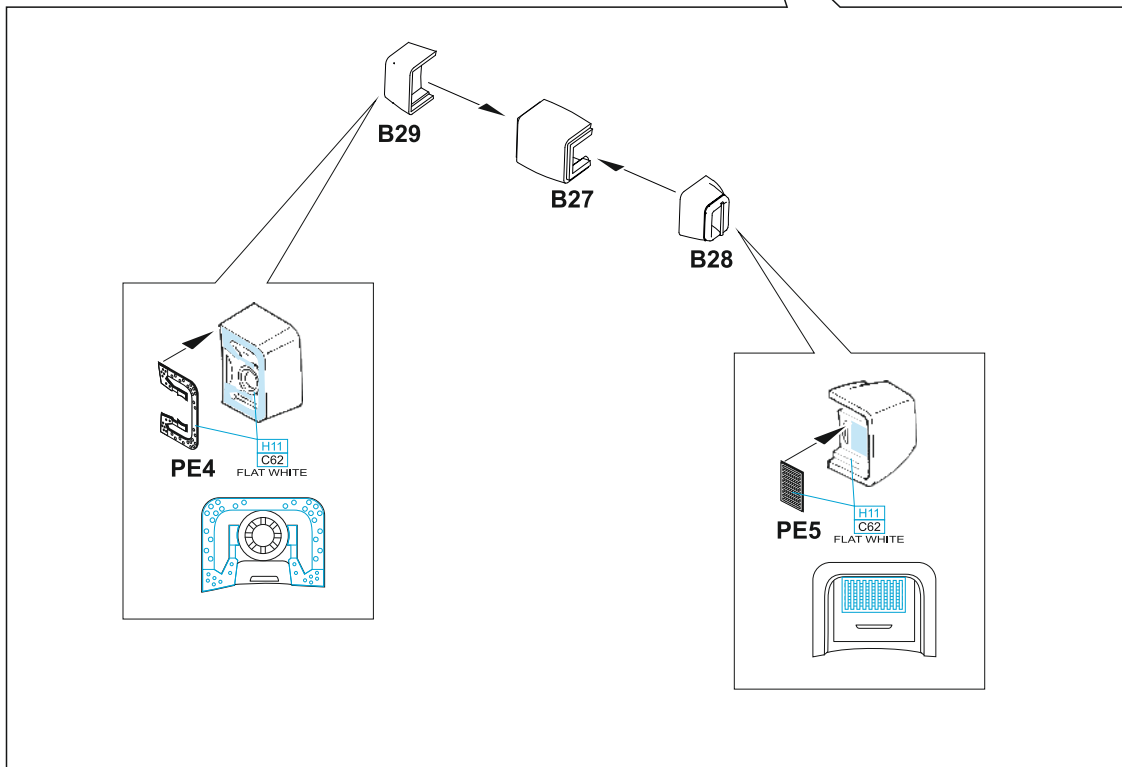
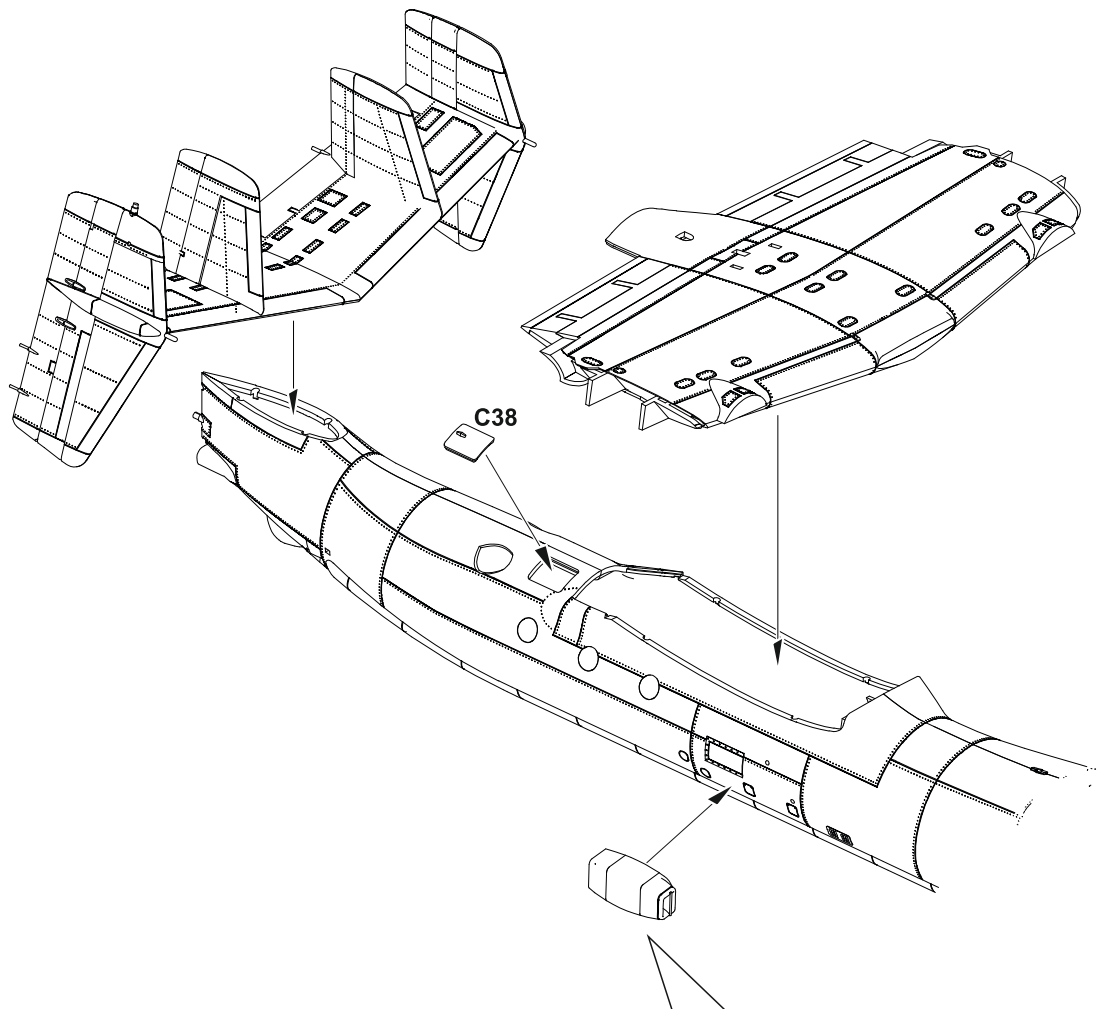

**B**

2 pcs.

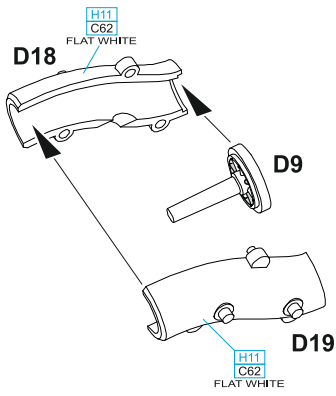

B17 B22  
B19 B15

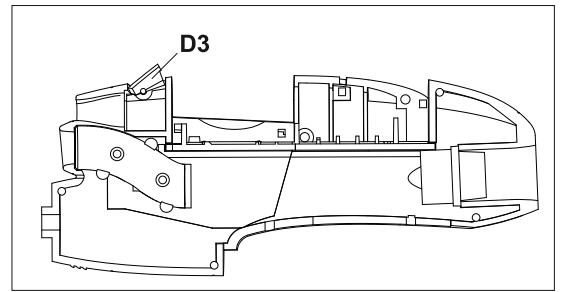
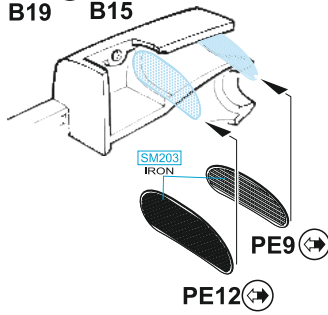

2 pcs.

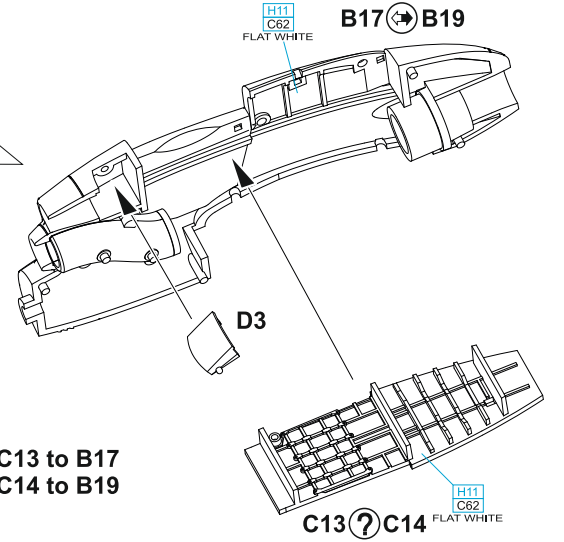
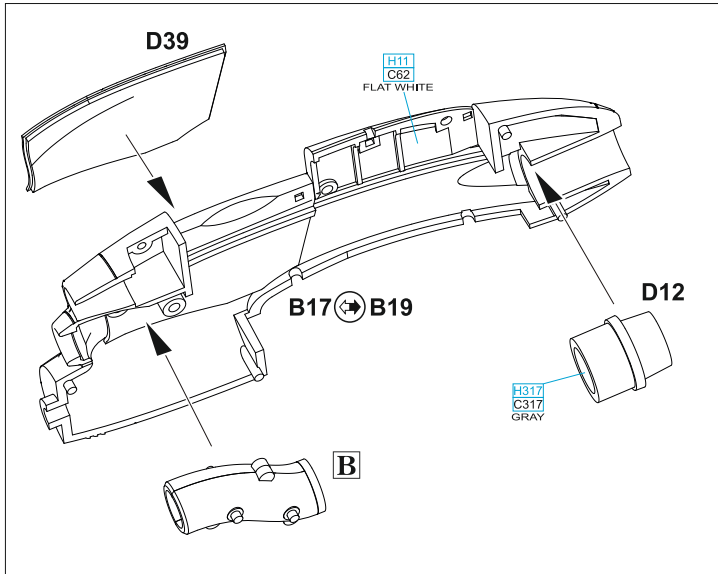

2 pcs.

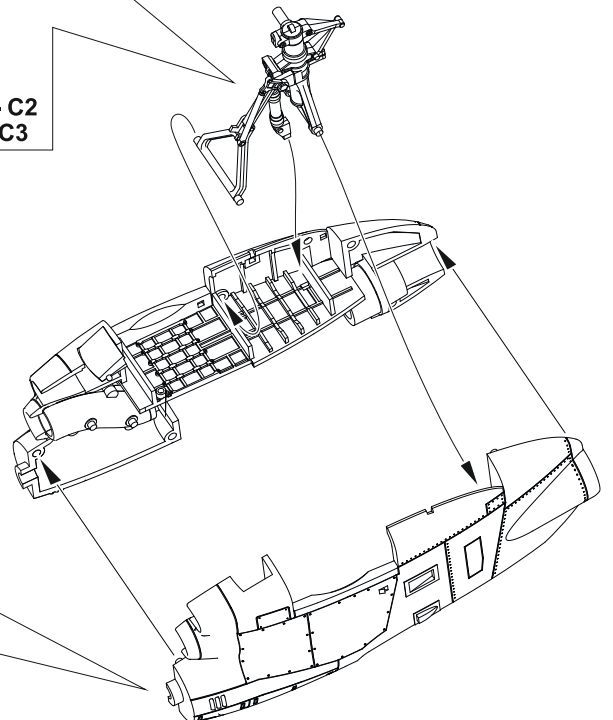
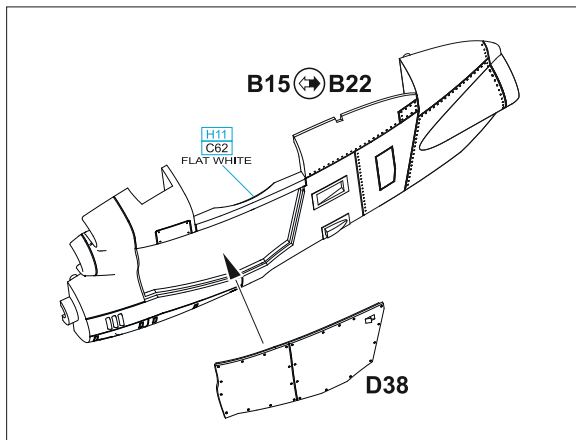
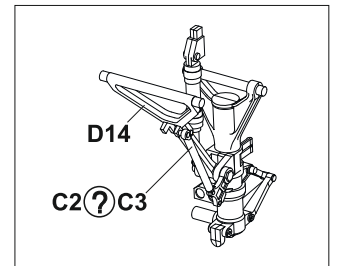
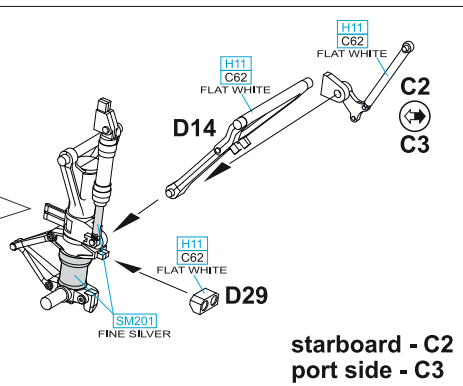
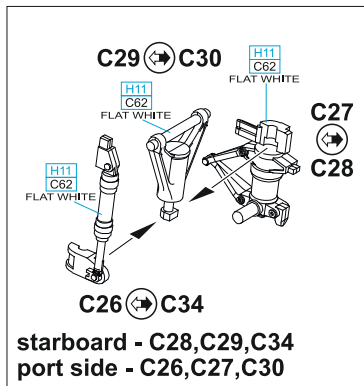

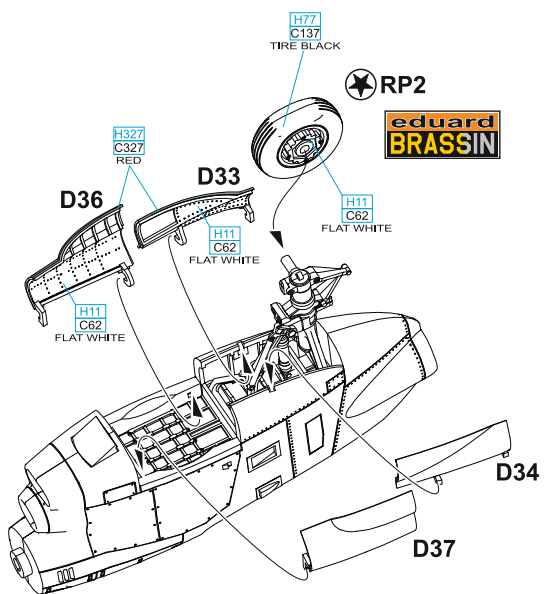
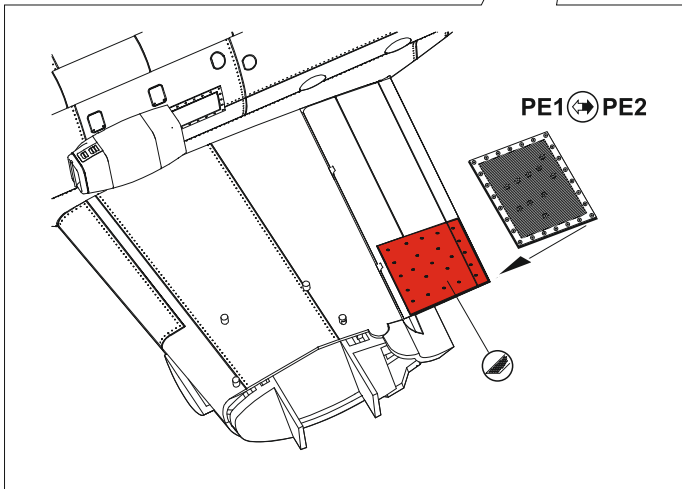
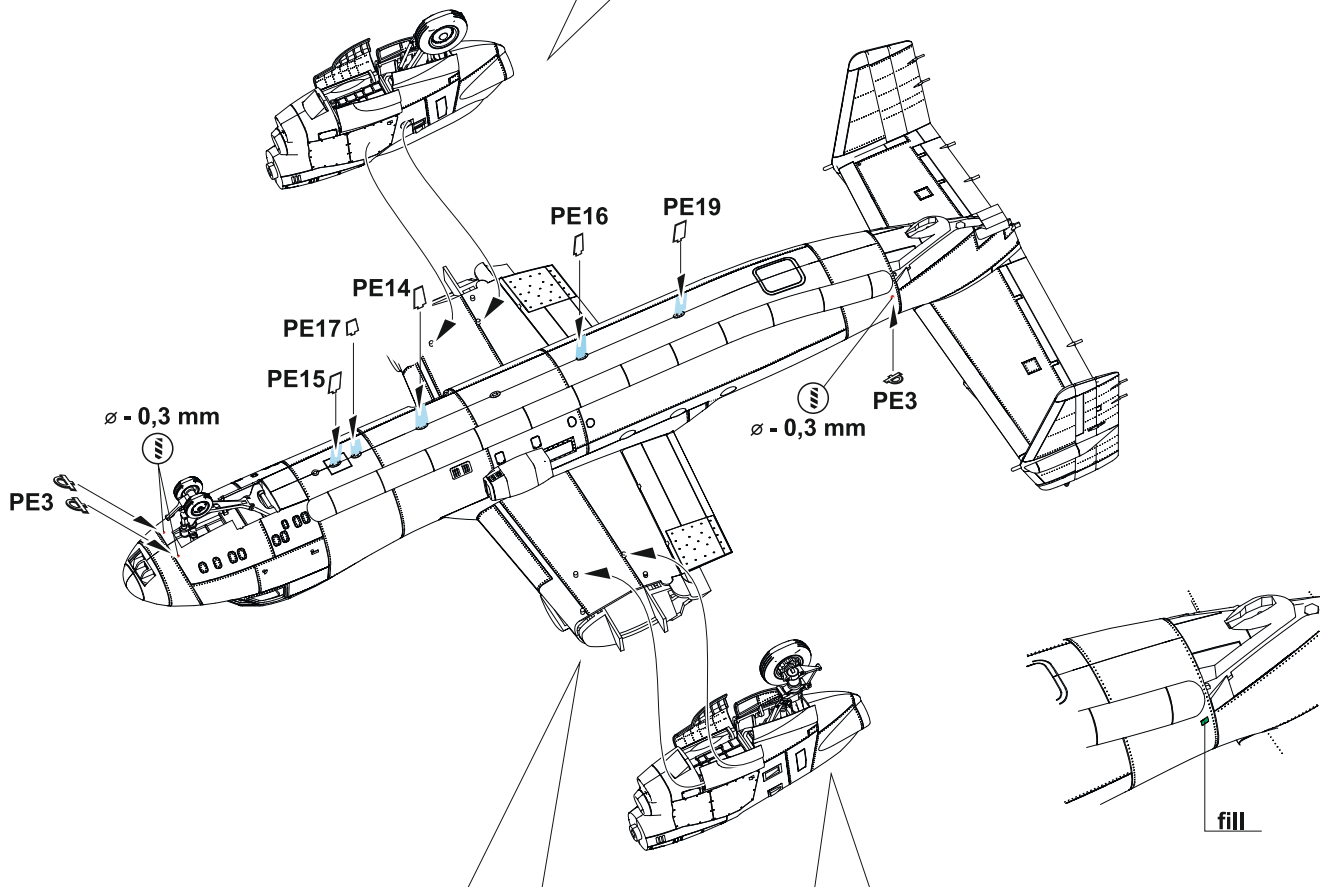
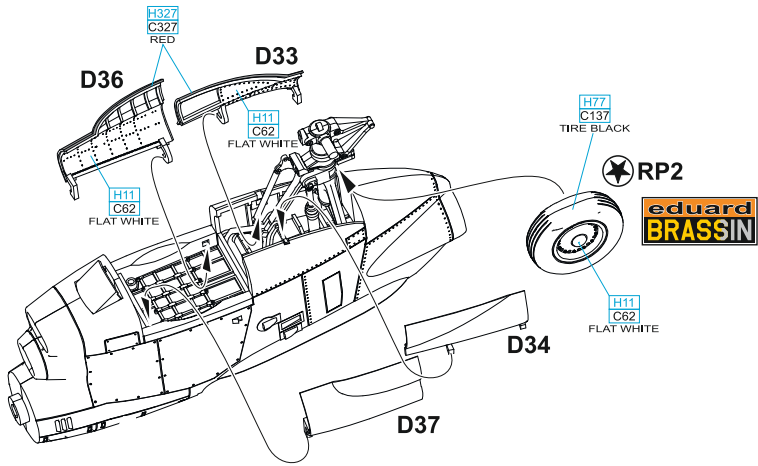
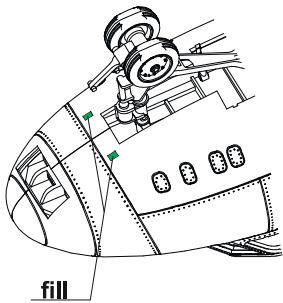

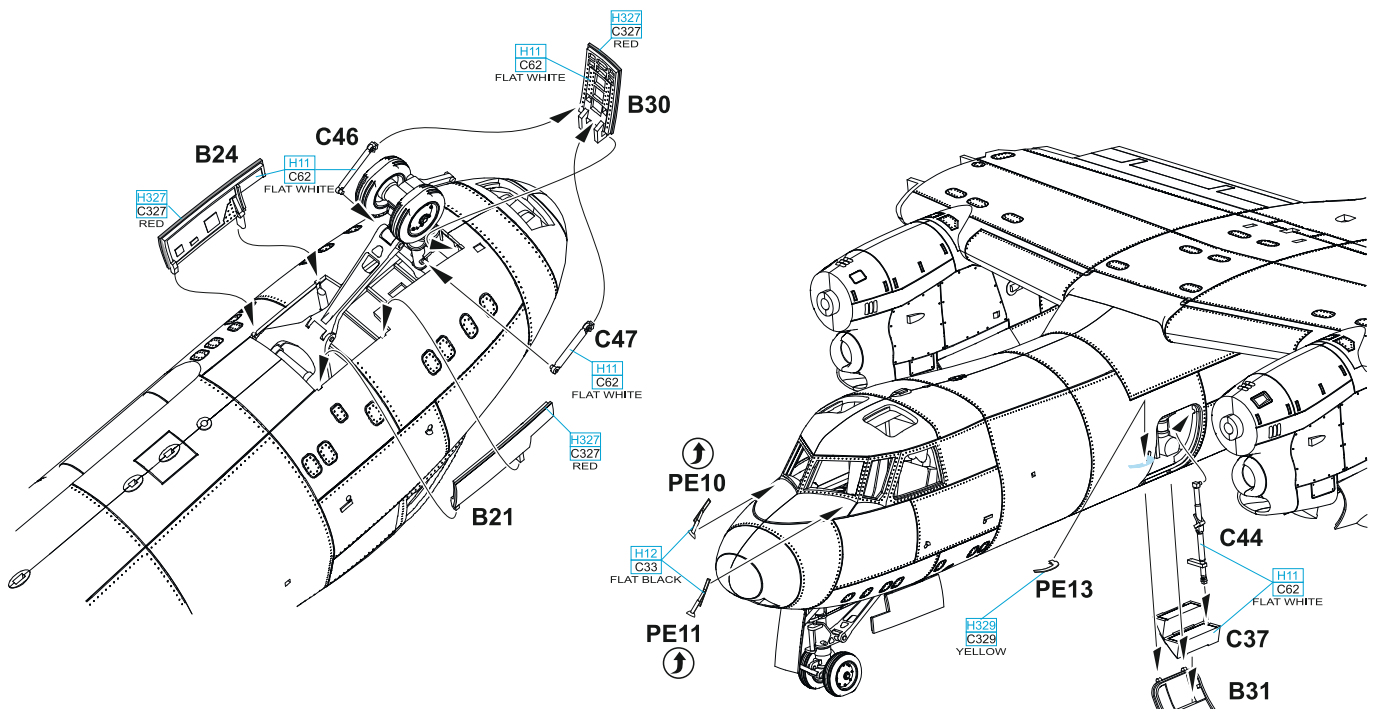

**B25 - MARKING B ONLY**

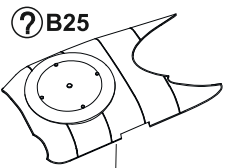

**PE14 - MARKINGS A, C, D ONLY**

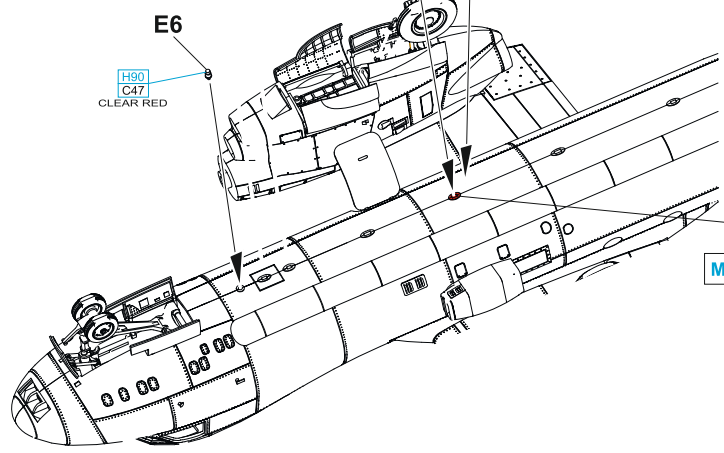

**MARKINGS A, C, D ONLY**

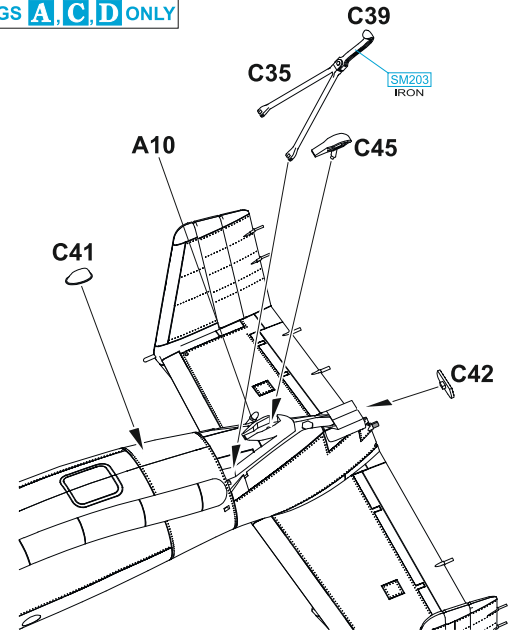
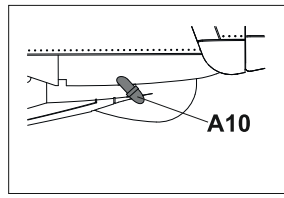
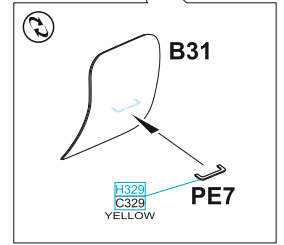

C

ONLY IF WINGS ARE EXTENDED

ONLY IF WINGS ARE EXTENDED

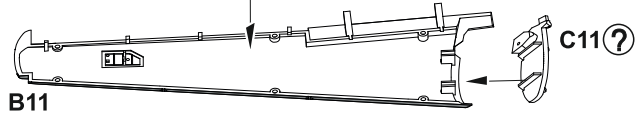
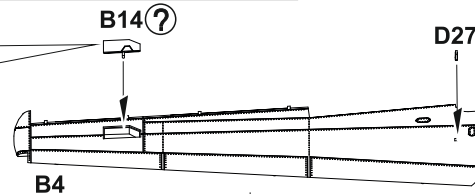
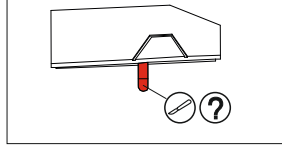

C11 - ONLY IF WINGS ARE FOLDED

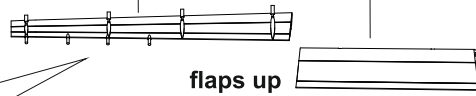
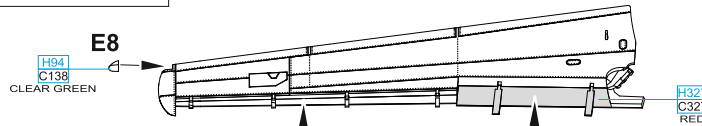
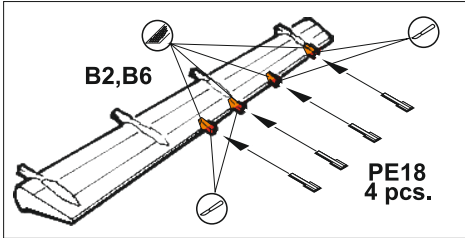

flaps up

?

flaps down

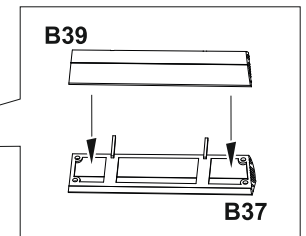
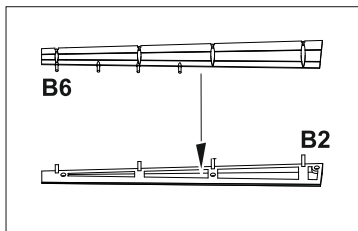

D

ONLY IF WINGS ARE EXTENDED

ONLY IF WINGS ARE EXTENDED

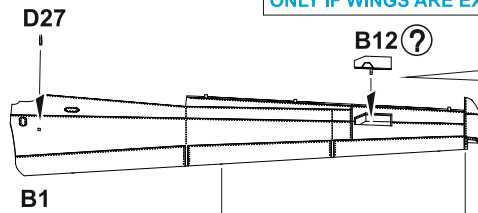

? C12

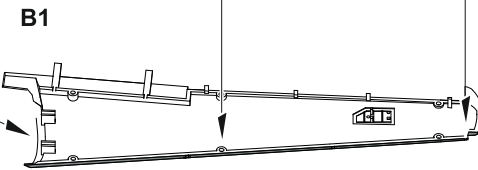

B7

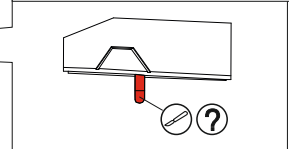

C12 - ONLY IF WINGS ARE FOLDED

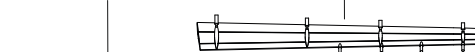
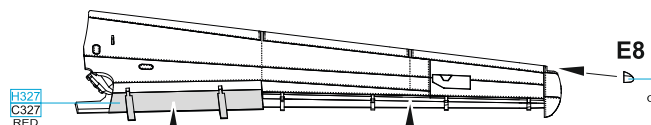
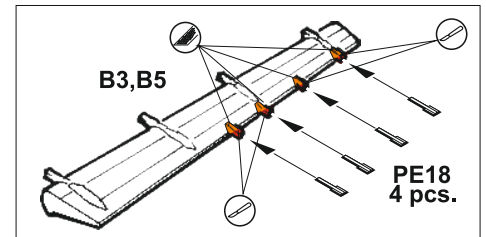

flaps up

?

flaps down

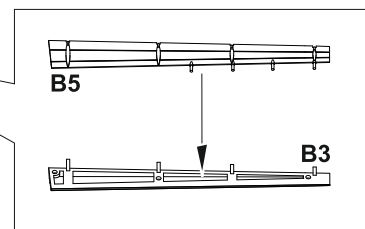
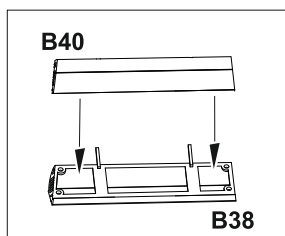

Wings Extended

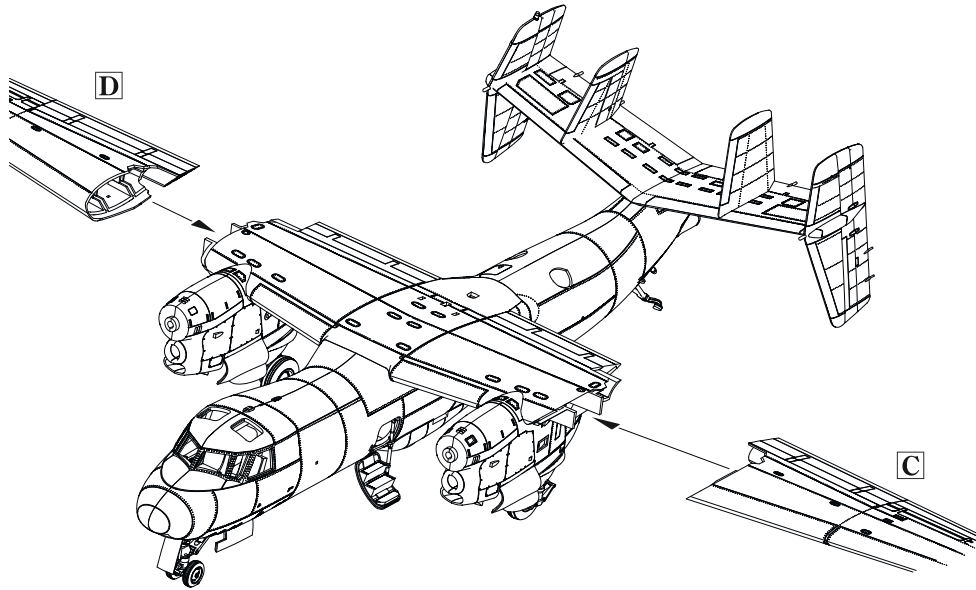

?

Wings Folded

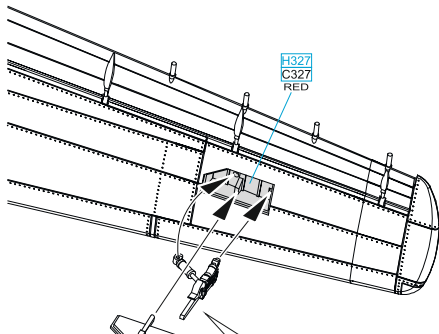

B12

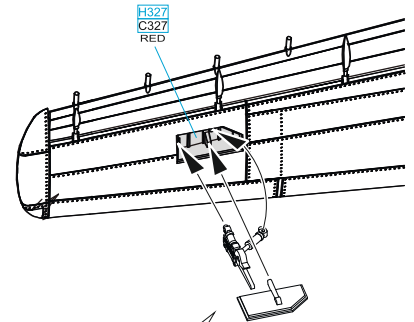
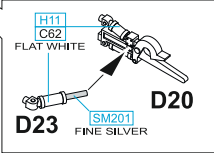

H327  
C327  
RED

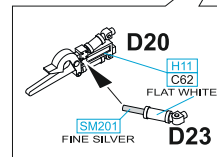

H11  
C62  
FLAT WHITE  
SM201  
FINE SILVER  
D20  
D23

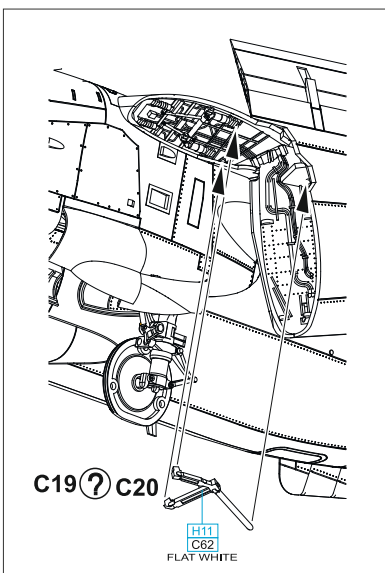

C19 ? C20

H11  
C62  
FLAT WHITE

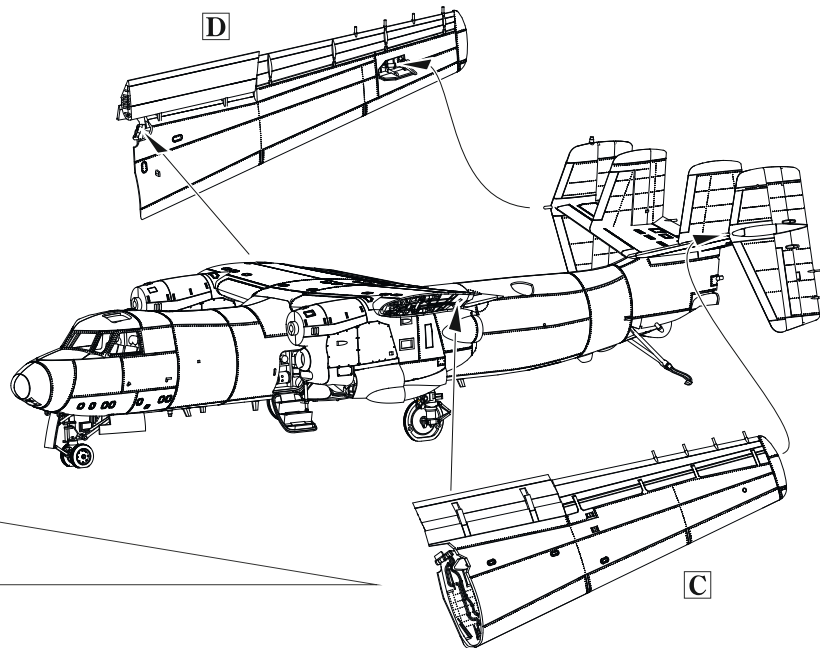

D

C

**E** MARKINGS **A, C, D** GLUE C7 OR C8 AFTER DECALING

C8 - MARKINGS **A, C**  
 C7 - MARKINGS **B, D**

C7 ? C8

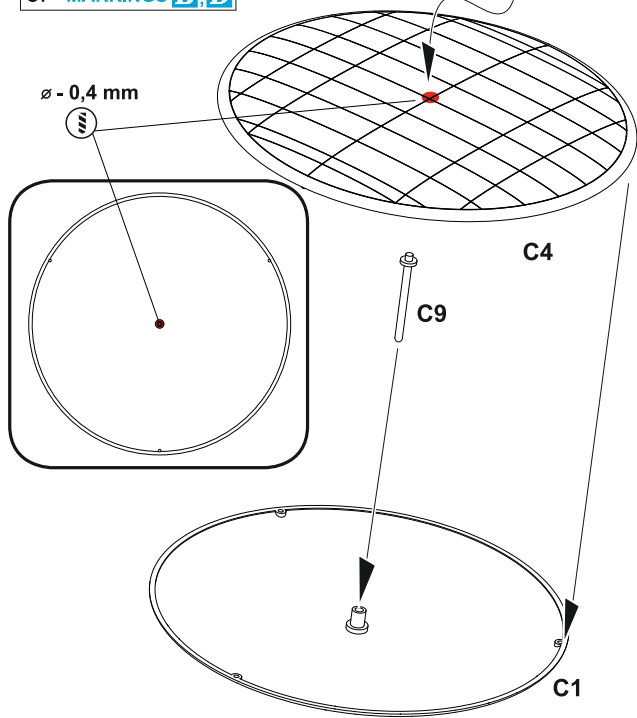

**F**

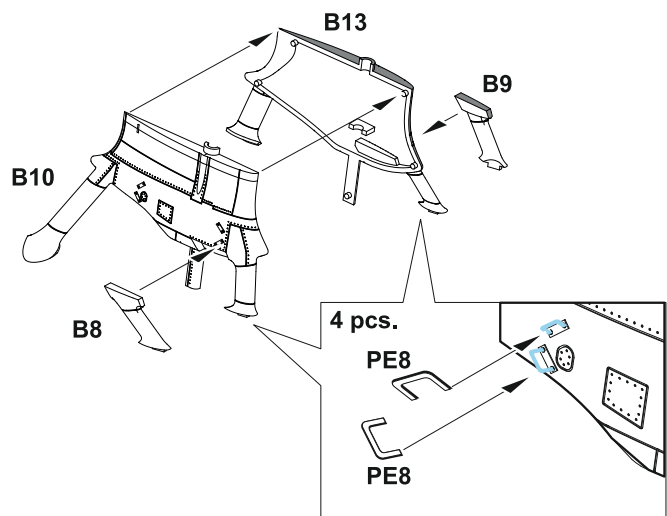

**G**

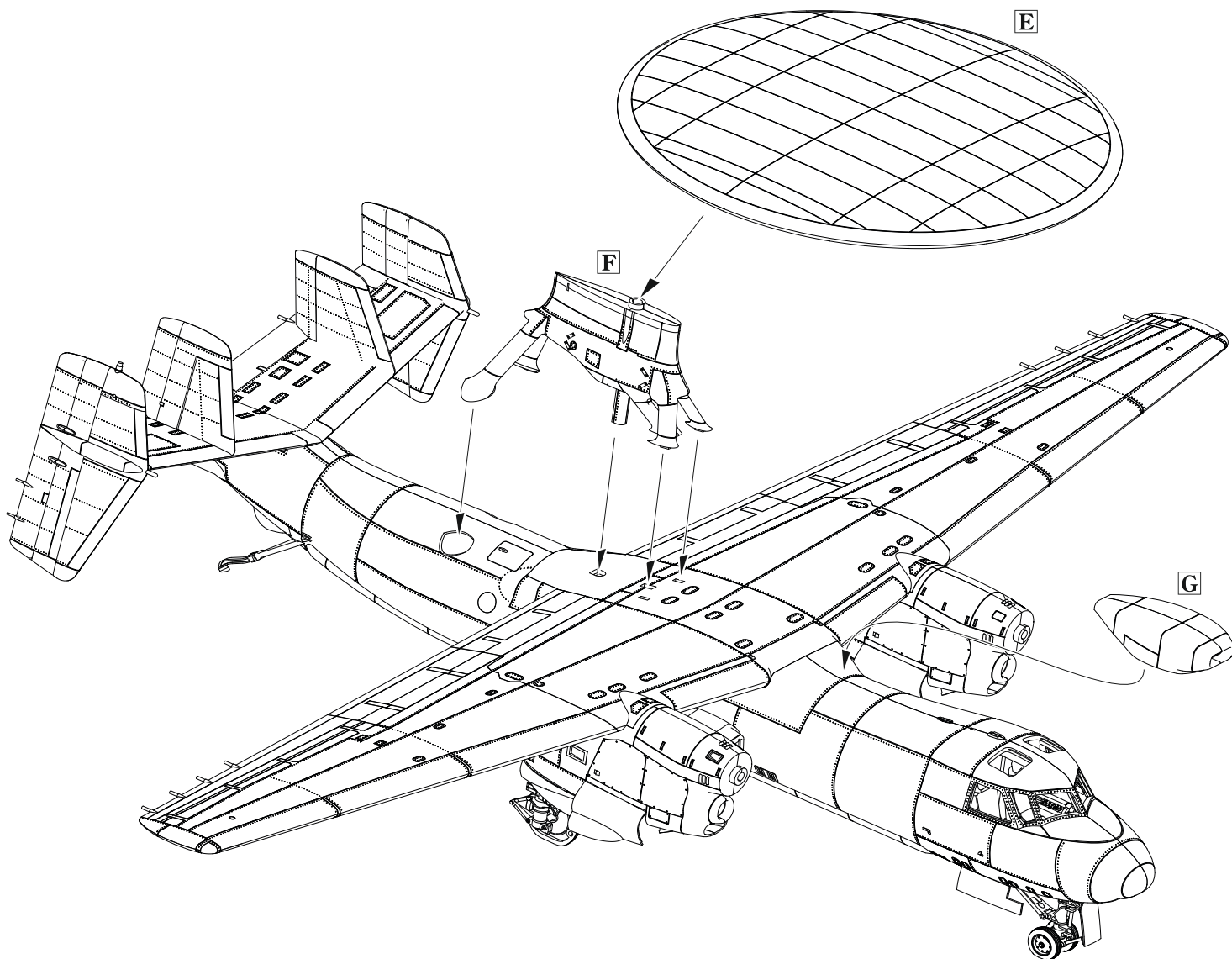
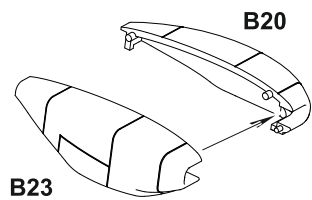

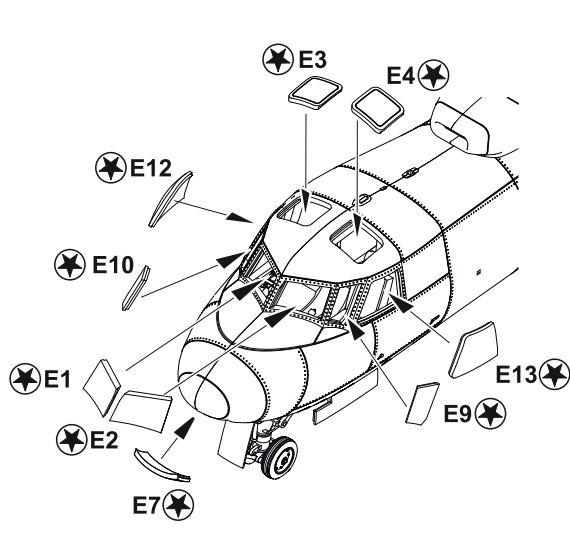

MARKINGS **A, B, D** ONLY

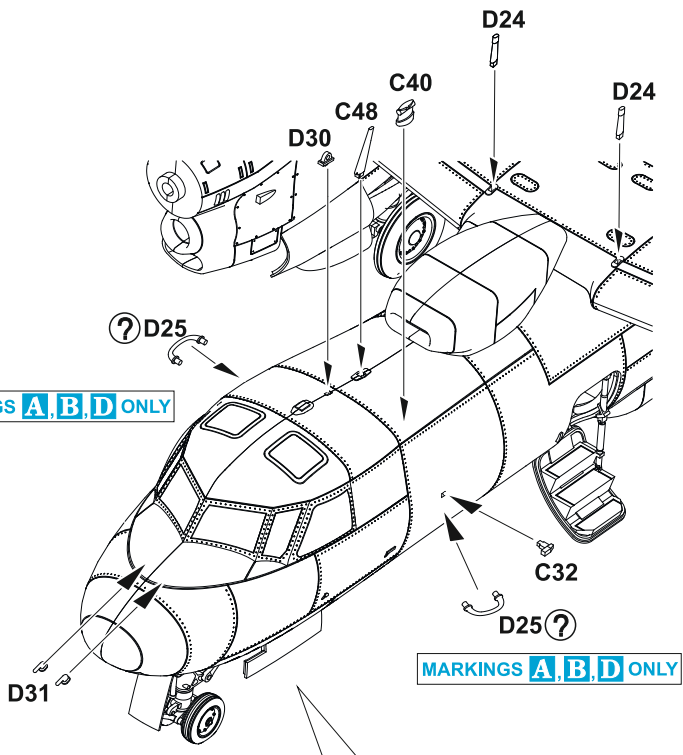

MARKINGS **A, B, D** ONLY

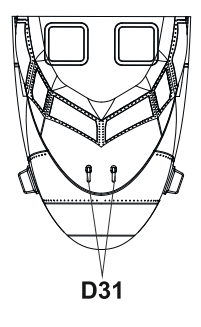

MARKING **C** ONLY

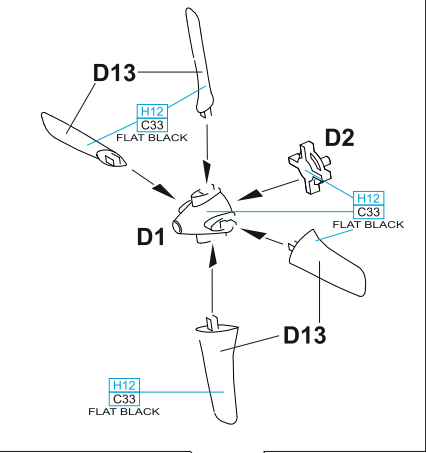

MARKINGS **A, B, D** ONLY

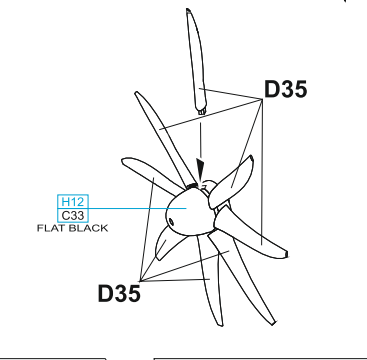

?

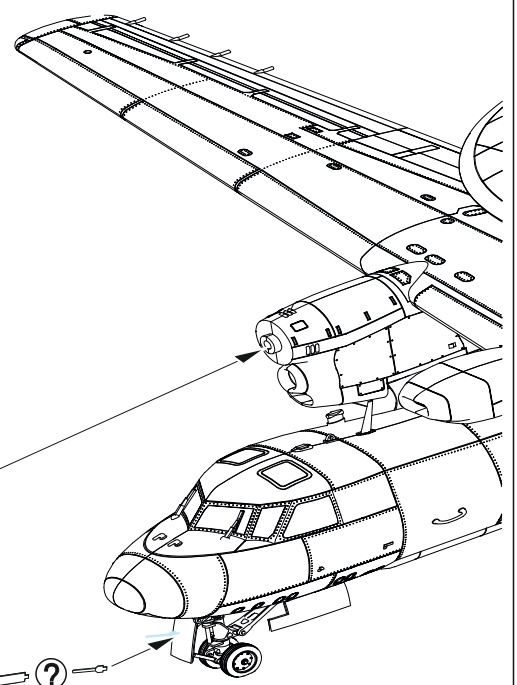
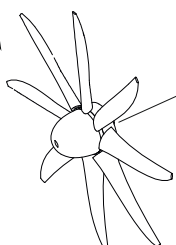
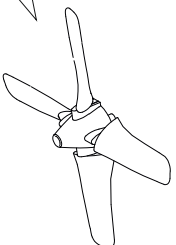

PE20 - MARKINGS **A, C, D**  
PE6 - MARKING **B**

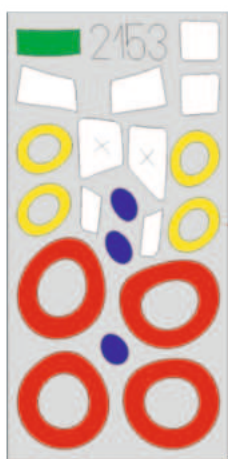

RP2

RP1

E11  
3 pcs.

E7

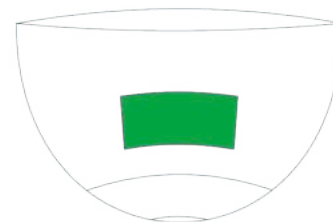
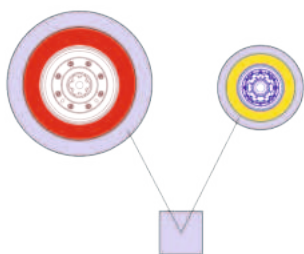

LIQUID MASK

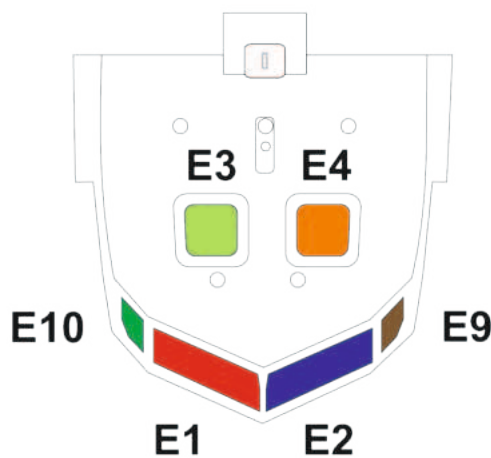
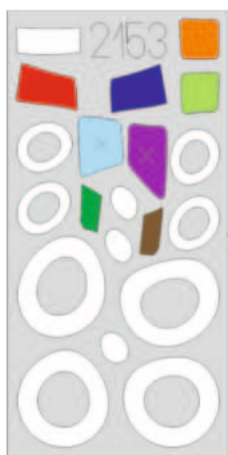

E12

E13

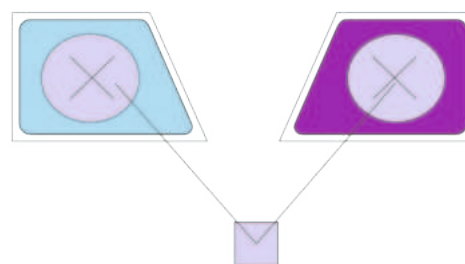

LIQUID MASK

# A BuNo. 163693, VAW-123 Screwtops, USS Enterprise (CVN-65), October 2005

Like its sister units, Airborne Command and Control Squadron 123 (VAW-123) was established on April 1, 1967, and was equipped with Grumman E-2 Hawkeye from the outset. Initially, these were E-2A, which were swapped for the E-2B version in 1969. In 1973, the E-2C version replaced the older variants and VAW-123 crews still fly them so far. The unit's home base, known as Screwtops, is NAS Norfolk, but when the Atlantic Fleet's aircraft carriers are at sea, they take off from their decks.

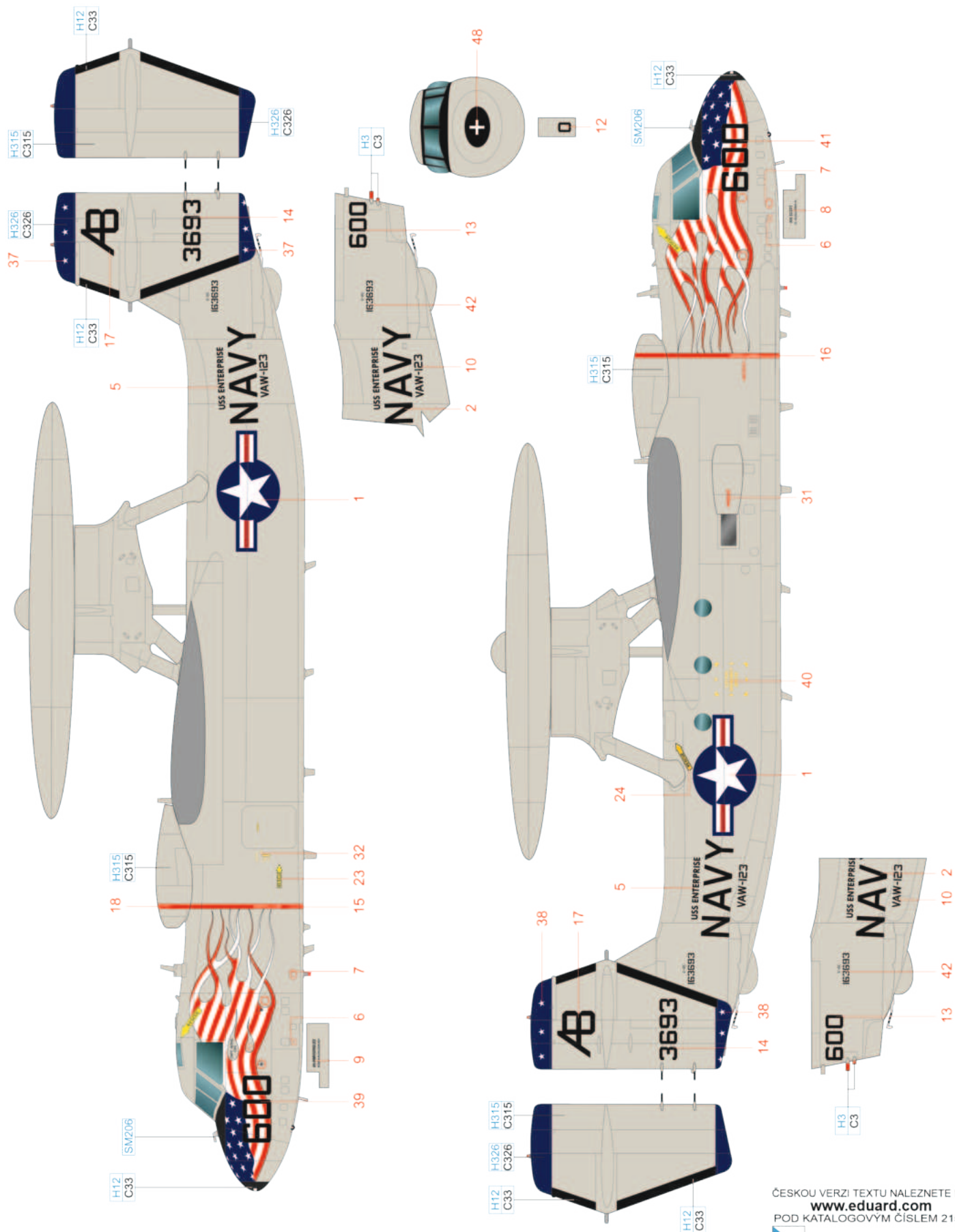

ČESKOU VERZI TEXTU NALEZNETE NA  
[www.eduard.com](http://www.eduard.com)  
 POD KATALOGOVÝM ČÍSLEM 2153



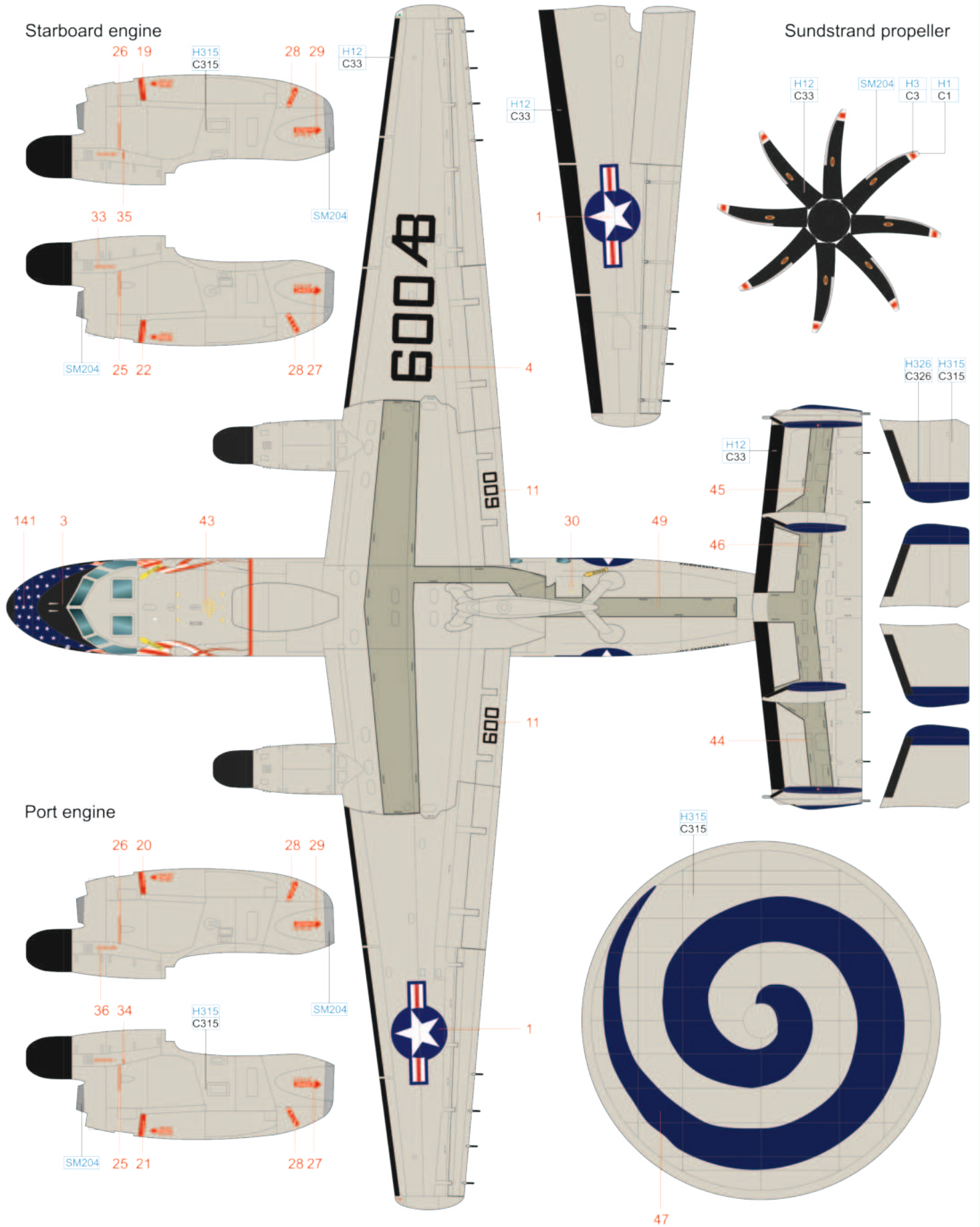

# B BuNo. 166503, VAW-120 Greyhawks, NAS Norfolk, United States, May 2010

The unit's history dates back to July 6, 1948, when Carrier Airborne Early Warning Squadron 2 (VAW-2) was established at NAS Norfolk, renamed VAW-12 in 1956. In July 1966, the unit received its first Hawkeye, version E-2A. VAW-12, which had 200 officers and 800 enlisted personnel, was reorganized on April 1, 1967, into an Air Wing with six operational squadrons, one of which was RVAW-120 (Replacement Airborne Early Warning Squadron), dedicated to crew training. In 1970, the unit received the E-2B version of the Hawkeye, and the E-2C version was delivered in 1973. In 1983, the unit was redesignated VAW-120. Currently, this unit uses E-2D and C-2A aircraft for training.

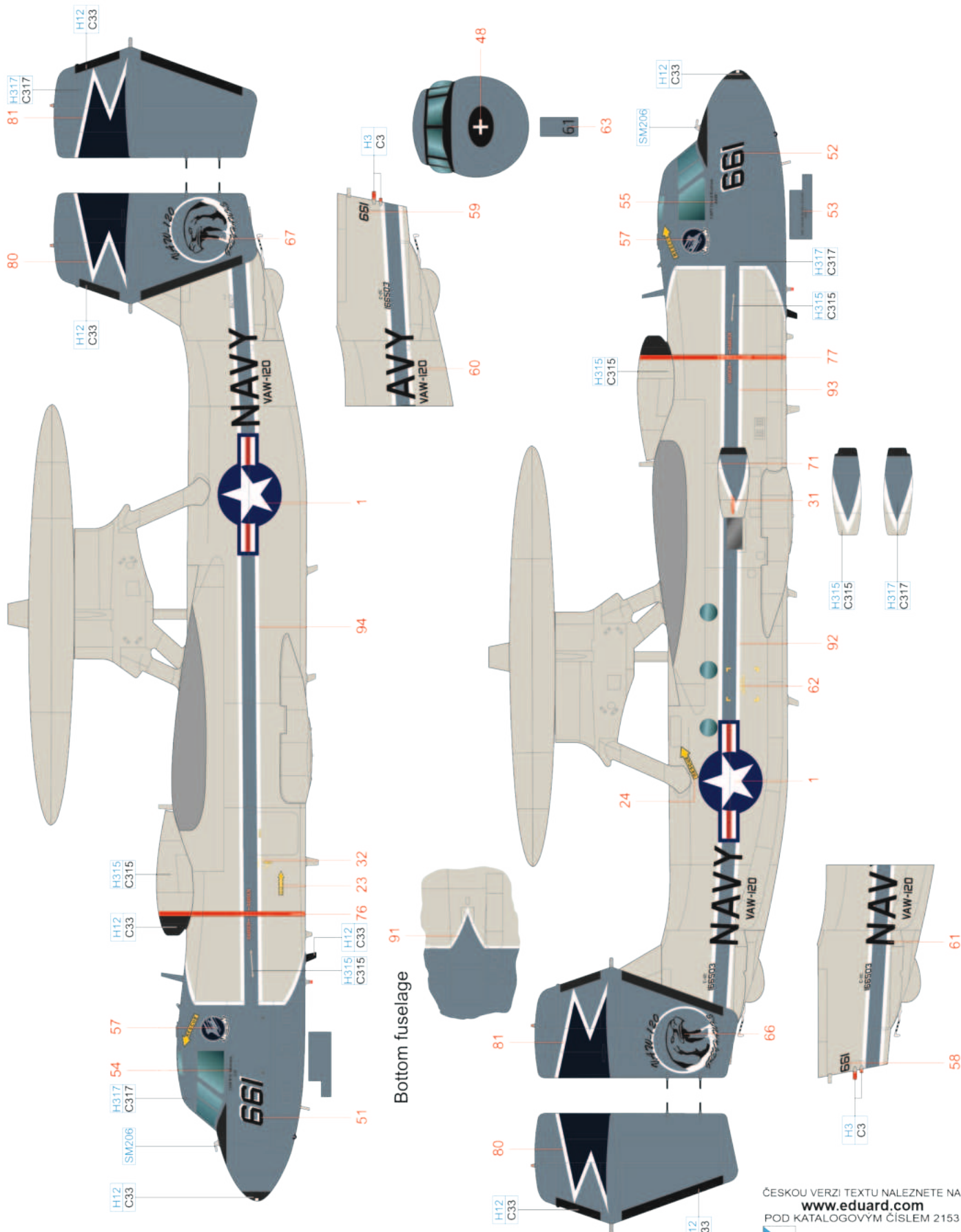

ČESKOU VERZI TEXTU NALEZNETE NA [www.eduard.com](http://www.eduard.com)  
 POD KATALOGOVÝM ČÍSLEM 2153

GRAY	H315 C315	FLAT BLACK	H12 C33	RED	H3 C3	GRAY	H317 C317	SKY	H74 C368	CLEAR YELLOW	H91 C48	SUPER STAINLESS 2	SM204	SUPER CHROME SILVER 2	SM206
------	--------------	------------	------------	-----	----------	------	--------------	-----	-------------	--------------	------------	-------------------	-------	-----------------------	-------



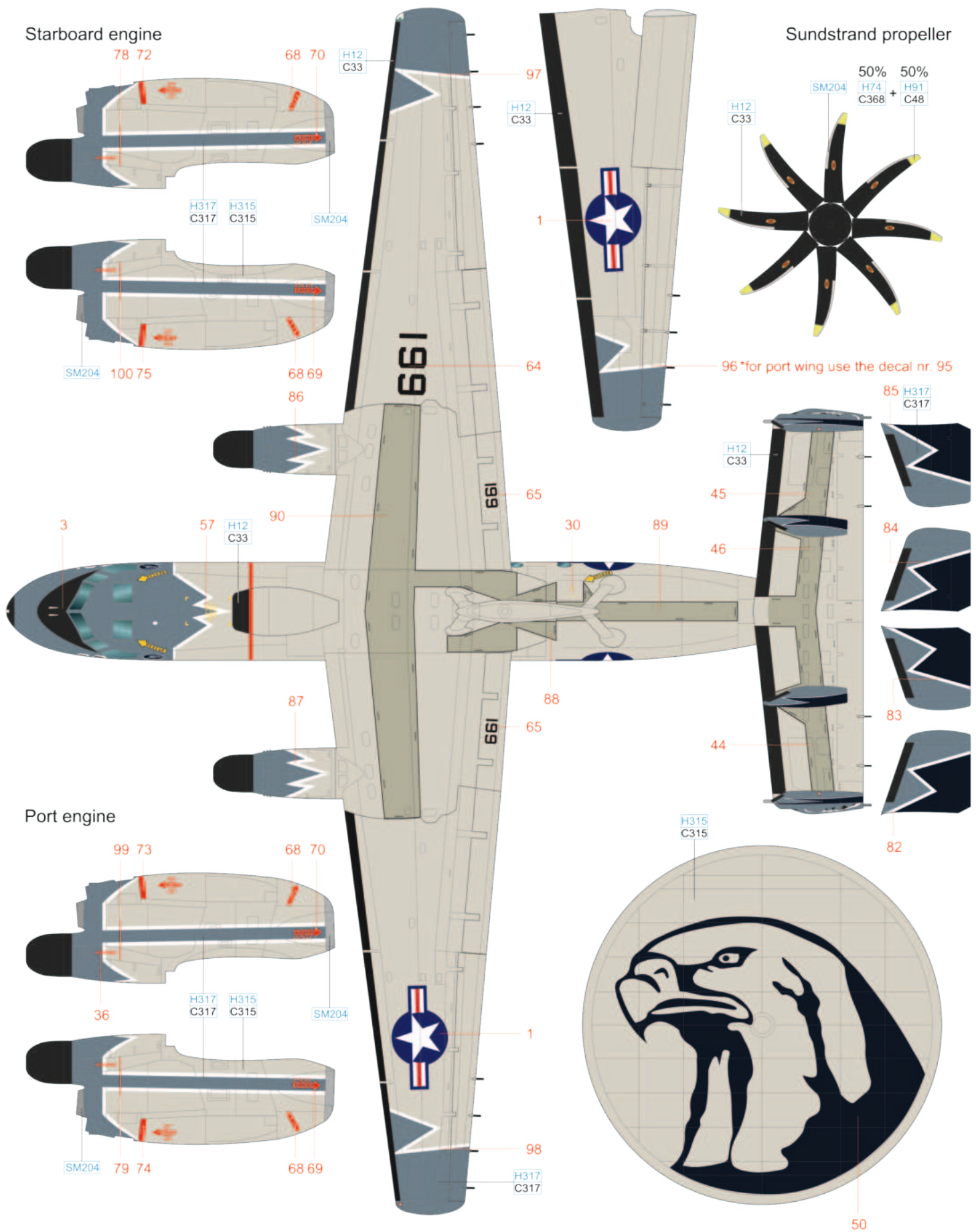

# C BuNo. 161346, VAW-121 Bluetails, USS George Washington (CVN-73), February 2004

Airborne Command and Control Squadron 121 (VAW-121) was established on April 1, 1967, and was initially equipped with Grumman E-1B Tracers. The reason for their use, even at a time when the US Navy already had Hawkeyes in service, was the inability to use E-2s on older Essex-class aircraft carriers and on the USS Franklin D. Roosevelt. The unit was re-equipped with modern E-2Cs in July 1975. The Bluetails, as the unit is nicknamed, use NAS Norfolk as their home base and are deployed on Atlantic Fleet aircraft carriers. In 2014, the unit was re-equipped with the more modern E-2D Advanced Hawkeye.

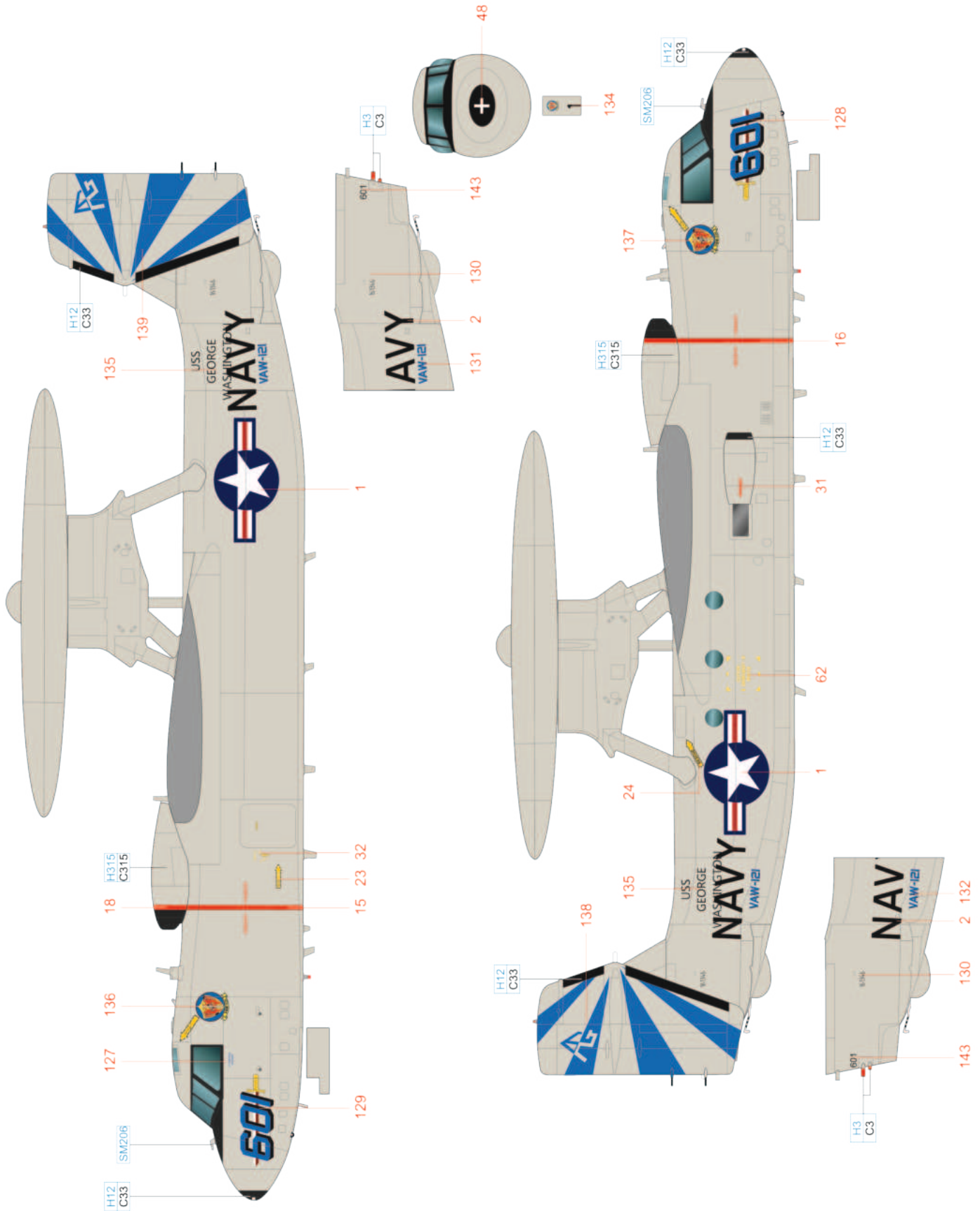

ČESKOU VERZI TEXTU NALEZNETE NA  
[www.eduard.com](http://www.eduard.com)  
 POD KATALOGOVÝM ČÍSLEM 2153



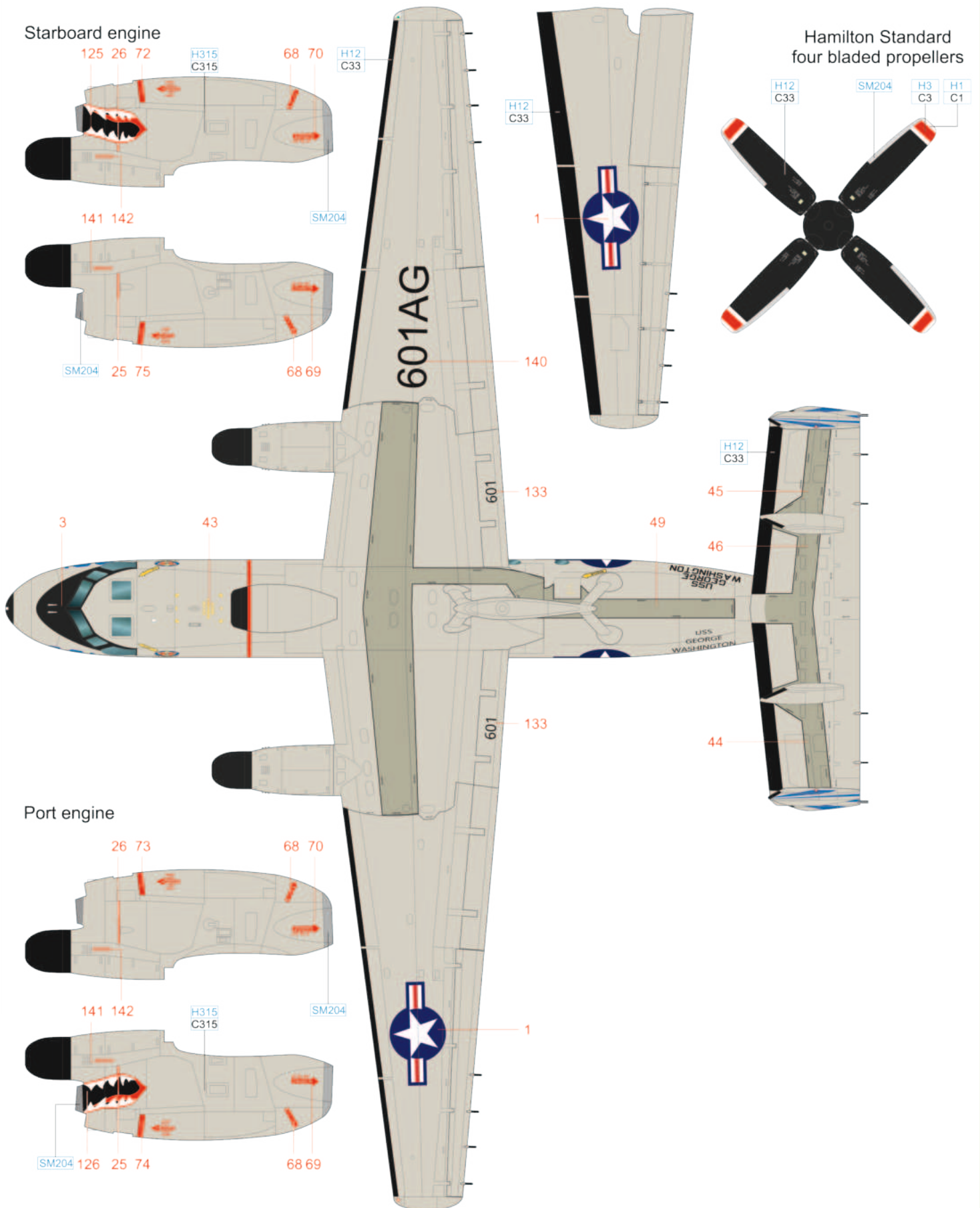

# D BuNo. 164483, VAW-124 Bear Aces, USS George H. W. Bush (CVN-77), May 2018

Airborne Command and Control Squadron 124 (VAW-124), also known by its nickname Bear Aces, was founded on September 1, 1967, at NAS Norfolk, which they still use today when not stationed aboard Atlantic Fleet aircraft carriers. From the beginning, Bear Aces were equipped with Grumman E-2 Hawkeye aircraft, from the A version to the most modern D version, which they fly since the summer of 2021.

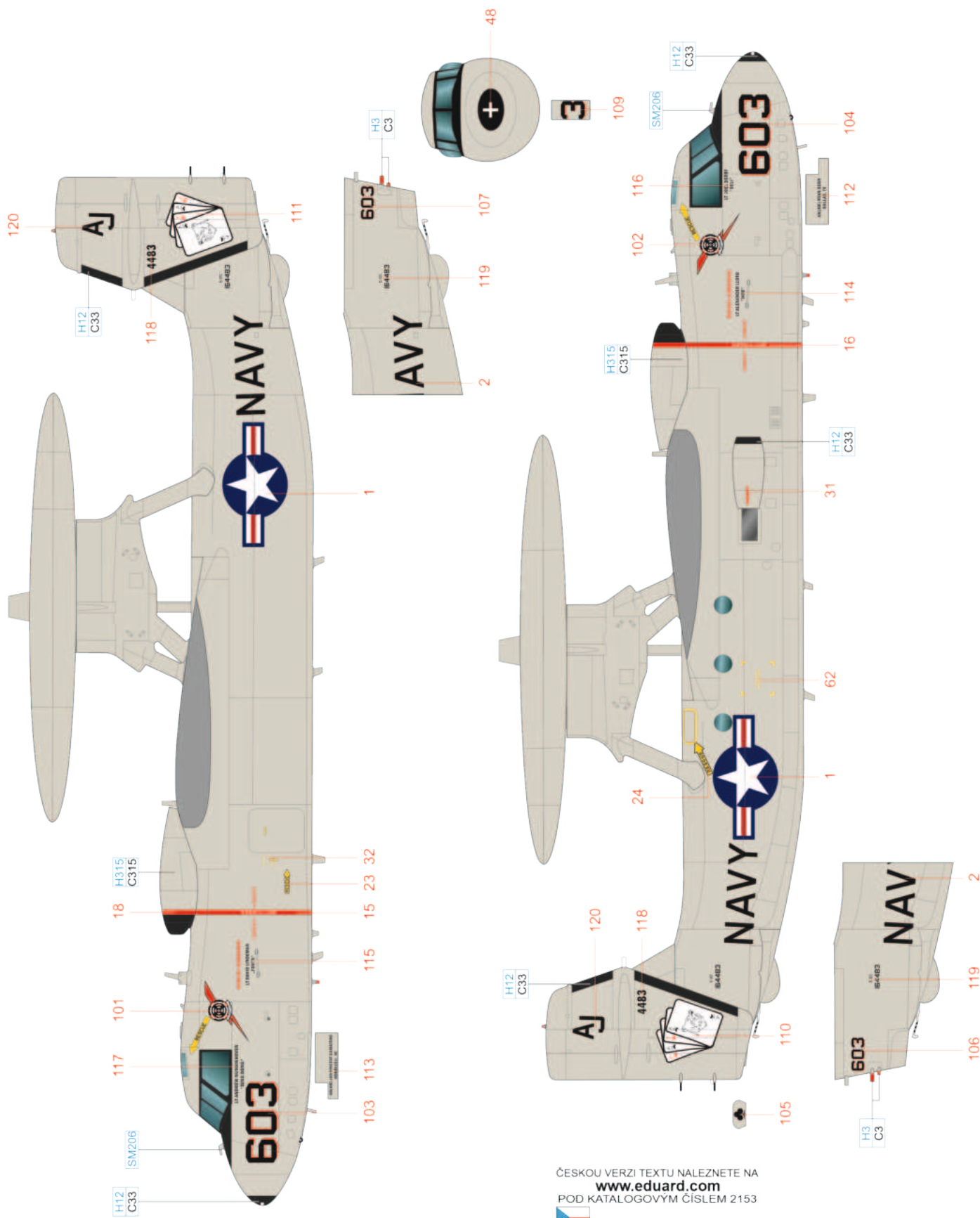

ČESKOU VERZI TEXTU NALEZNETE NA  
[www.eduard.com](http://www.eduard.com)  
 POD KATALOGOVÝM ČÍSLEM 2153



- GRAY H315 C315
- FLAT BLACK H12 C33
- RED H3 C3
- SKY H74 C368
- CLEAR YELLOW H91 C48
- SUPER STAINLESS 2 SM204
- SUPER CHROME SILVER 2 SM206

